

2.1 INTERLOCKING SYSTEMS

arcoPlus®
324

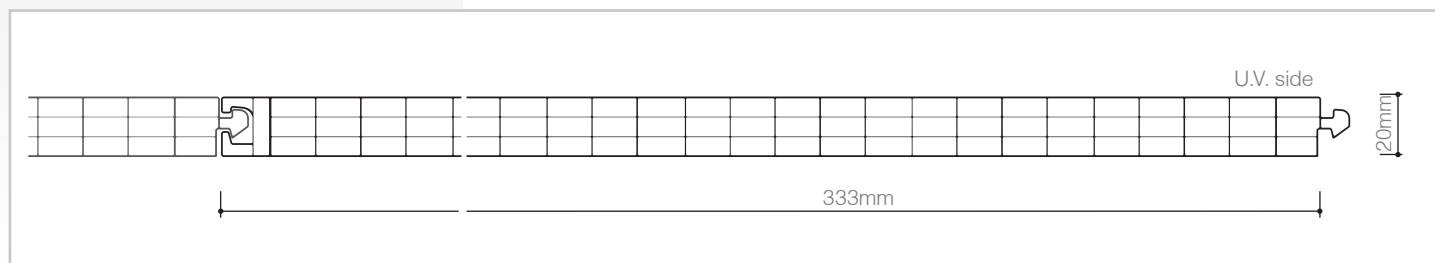

PROFILE



**Modular system of
UV protected multiwall
polycarbonate for
translucent curtain
walls and glazing
applications**

PRODUCTION STANDARDS

thickness	20mm
structure	4 walls
effective modular width	333mm
panel length	no limit
colours available	see page 11

TECHNICAL FEATURES

Thermal insulation	1,8 W/m ² K
Acoustic insulation	16 dB
Linear thermal expansion	0,065mm/m°C
Temperature range	-40°C +120 °C
U.V. rays protection	Coextrusion
Fire reaction EN 13501	EuroClass B-s1,d0

DESCRIPTION

arcoPlus®324 is a modular system of coextruded 4 walls polycarbonate panels with a thickness of 20mm, aluminium profiles, accessories and opening windows, designed for simple and versatile use.

arcoPlus®324 is not suitable for roofing applications.

Caleido

LIGHT MANAGEMENT

ADVANTAGES

- ❖ Easy and low-cost installation
- ❖ Light transmission
- ❖ Resistance to U.V. rays and to hail
- ❖ Heat insulation

APPLICATIONS

- ▶ Vertical windows

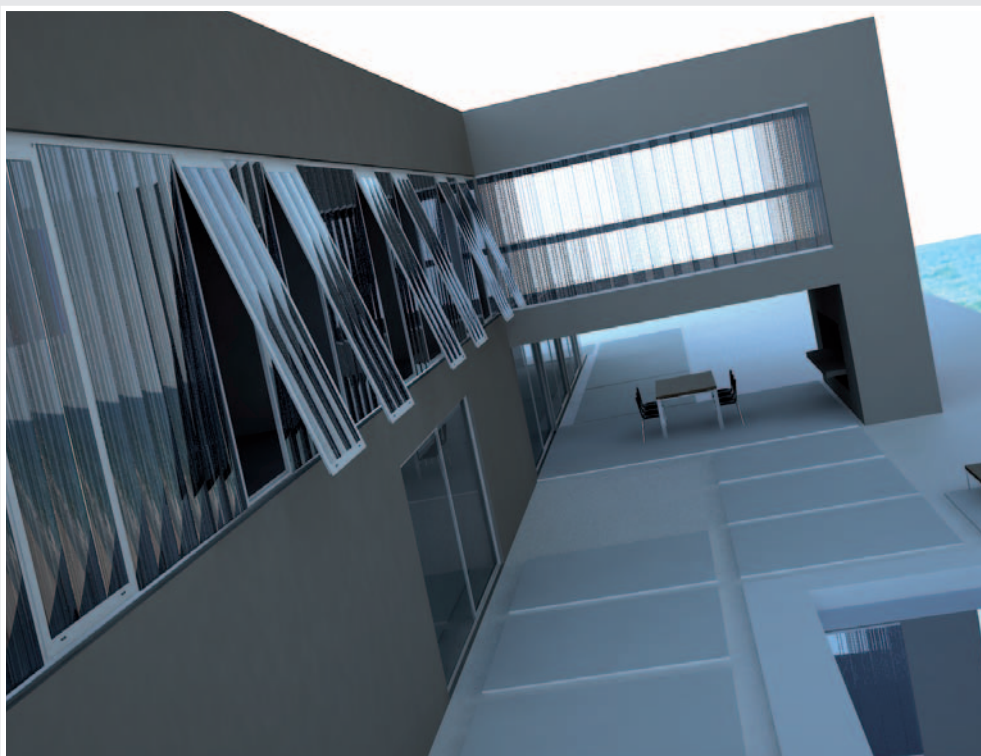



LOAD RESISTANCE

Maximum loads on two supports

Values below refer to product installed according to the Technical Handbook Recommendation

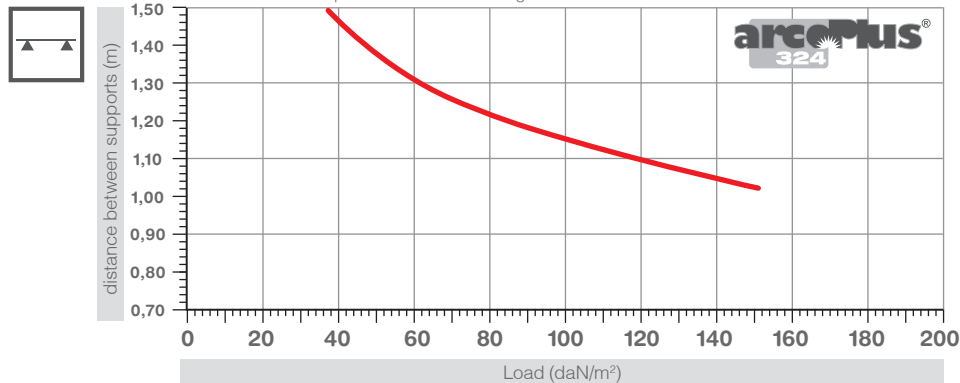

Maximum loads on more supports

Values below refer to product installed according to the Technical Handbook Recommendation

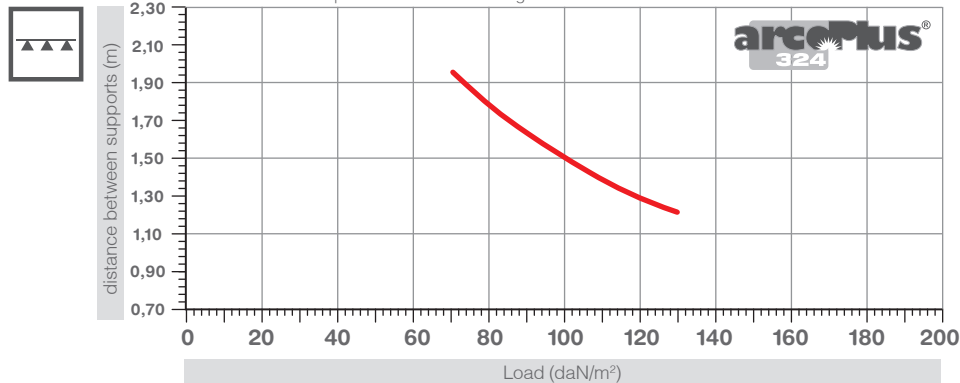

EASY AND LOW-COST INSTALLATION

The 20mm-thick, 4 walls structure with tongue and groove connection gives the panels remarkable flexural strength. It also allows the panels to be installed without the use of metal reinforcement frames, thus eliminating heat loss due to the thermal bridges caused by these structures.

The modular connection ensures a watertight seal for glazing with an inclination of up to 30°.

For installations exceeding 1.5m, a suitable section-breaker profile must be installed to which the arcoPlus® panels can then be fixed (see load resistance graph). This is done using the specific brackets to give the system

the necessary resistance to negative wind load and permit sliding due to thermal expansion.



INSERTION OF PLATE
Insertion of stainless steel plates for anchorage to existing structures.



**CALCULATION AND INSTALLATION
EXAMPLES OF PANEL LENGTH (PL)**

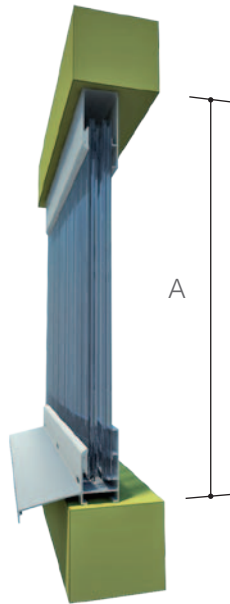

**WITH
EAVE**
 $PL = A - 50 \text{ mm}$
 $A = \text{opening measure}$

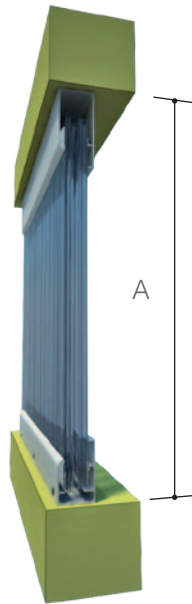

**WITHOUT
EAVE**
 $PL = A - 40 \text{ mm}$
 $A = \text{opening measure}$

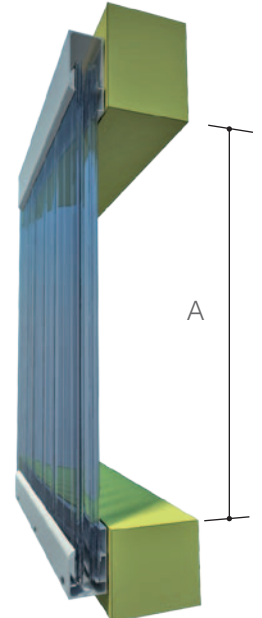

**OUTSIDE OF
THE BUILDING**
 $PL = A + 80 \text{ mm}$
 $A = \text{opening measure}$

VERTICAL GLAZING
 Construction of continuous transparent
 glazing, with section-breaker profile.

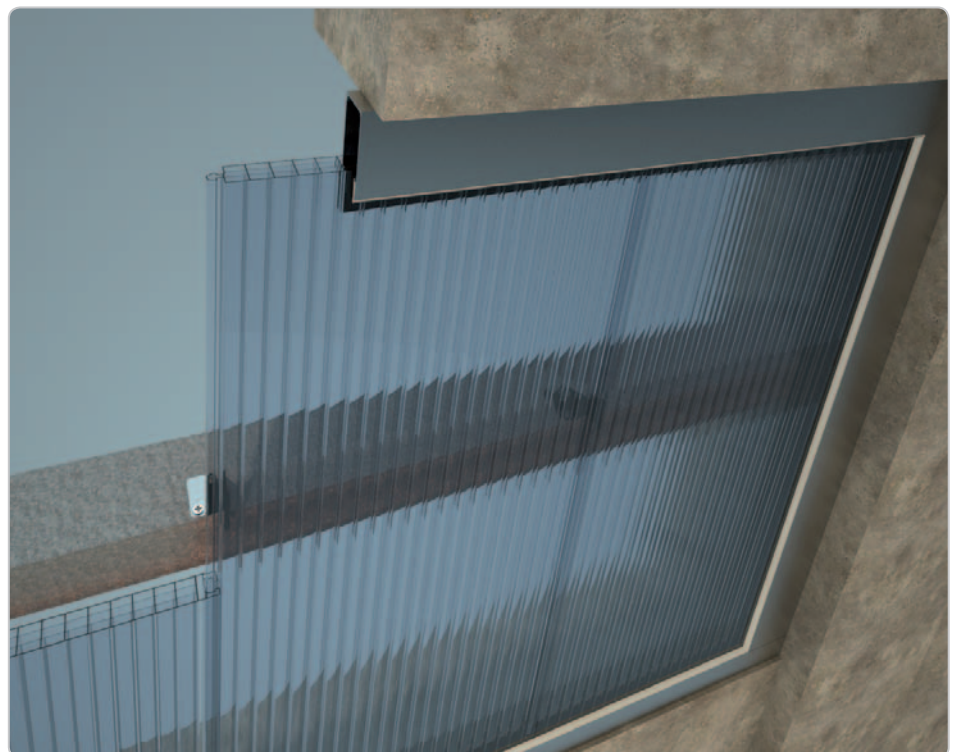



ACCESSORIES

The system includes a complete range of aluminium profiles for installing the panels.

The air cells of the polycarbonate panels must be sealed using vented aluminium breather tape. This allows correct ventilation and prevents soiling on the inside.

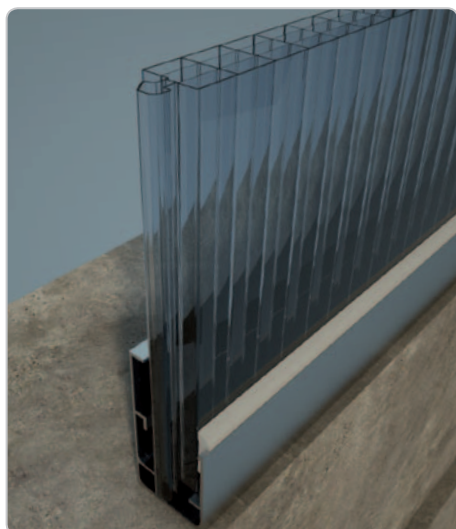

BASE PROFILE

Insertion of curtain wall panels on base profile, with gasket.

METAL PROFILES

code 4062
Base AL profile

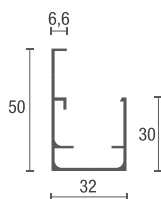

code 4064
Base AL profile with eave

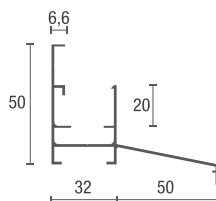

code 4061
Upper and side AL profile

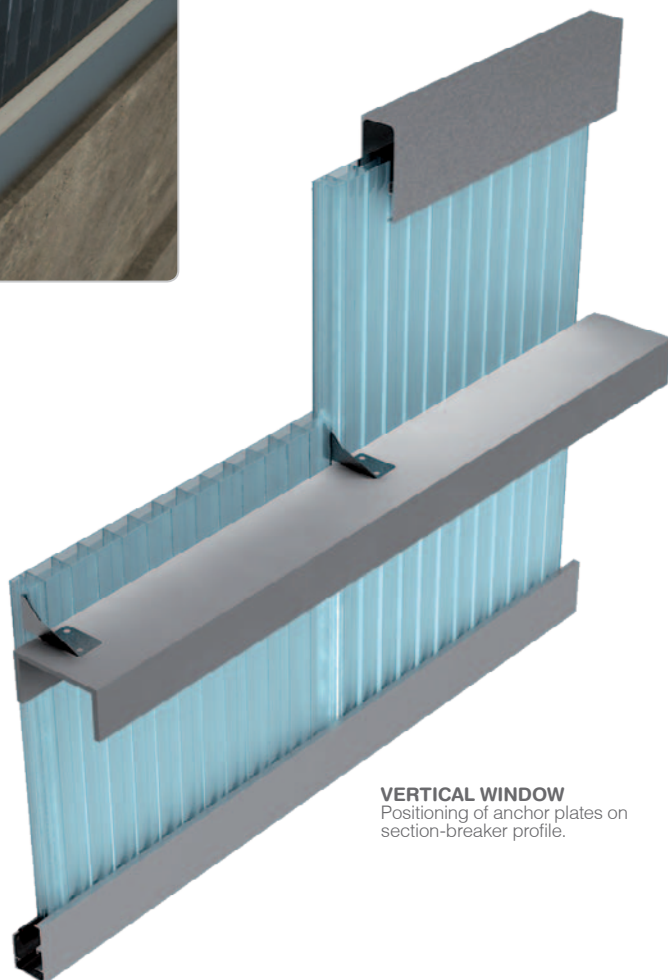
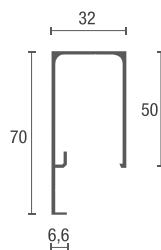

VERTICAL WINDOW

Positioning of anchor plates on section-breaker profile.

ACCESSORIES



4062

Base AL profile



4064

Base AL profile with eave



4061

Upper and side AL profile



1169/B

Slip Coat Gasket



4063

Link plate



4066

Additional sealing tape