

2.2 MODULAR CONNECTOR SYSTEMS

arcoPlus®
Reversò 684|6104|6124
8mm 10mm 12mm

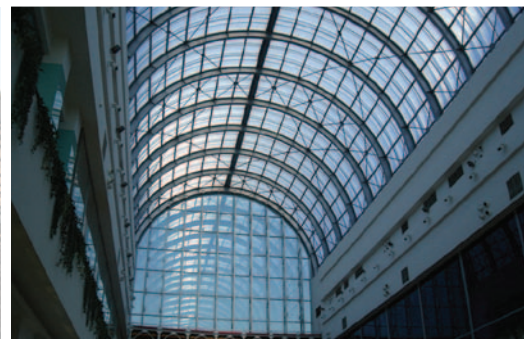

PROFILE

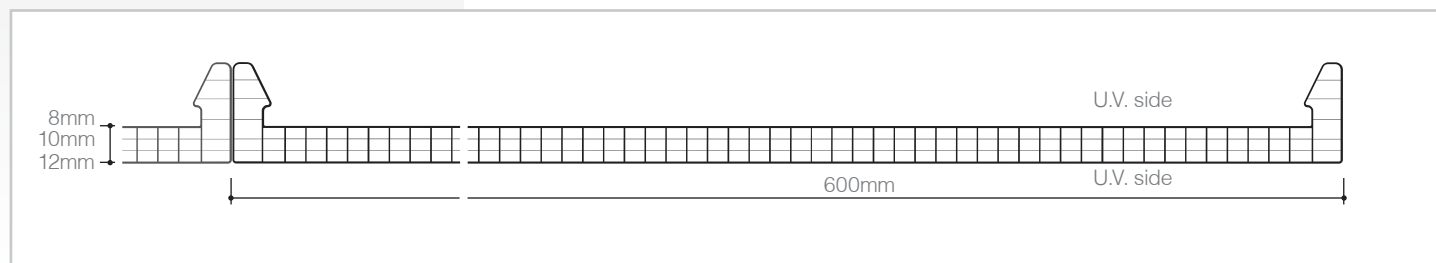

Modular system of bi-protected multiwall polycarbonate for translucent roofing applications



LIGHT MANAGEMENT



PRODUCT AVAILABLE
WITH IR AND AR TREATMENT

PRODUCTION STANDARDS

thickness	8-10-12mm
structure	4 walls
effective modular width	600mm
panel length	no limit
colours available	see page 11

TECHNICAL FEATURES

Thermal insulation	3,3 - 3,0 - 2,7 W/m²K
Acoustic insulation	18 dB (th.8-10mm) 19dB (th.12mm)
Linear thermal expansion	0,065mm/m°C
Temperature range	-40°C +120 °C
U.V. rays protection	2 sides Coextrusion
Fire reaction EN 13501	EuroClass B-s1,d0

DESCRIPTION

arcoPlus®684-6104-6124 reversò are three modular systems consisting of 4 walls polycarbonate panels with UV protection on two sides and thicknesses of 8-10-12mm. They are anchored to the existing structures using specific anchor brackets. The panels are joined together using a protected polycarbonate or aluminium cover plate profile assembled using a click-on system to guarantee a perfectly watertight seal.

ADVANTAGES

- ❖ Easy and low-cost installation
- ❖ Light transmission
- ❖ Resistance to U.V. rays and to hail
- ❖ Heat insulation
- ❖ Bendability R.min=2,5m

APPLICATIONS

 Roofing

 Curved roofing

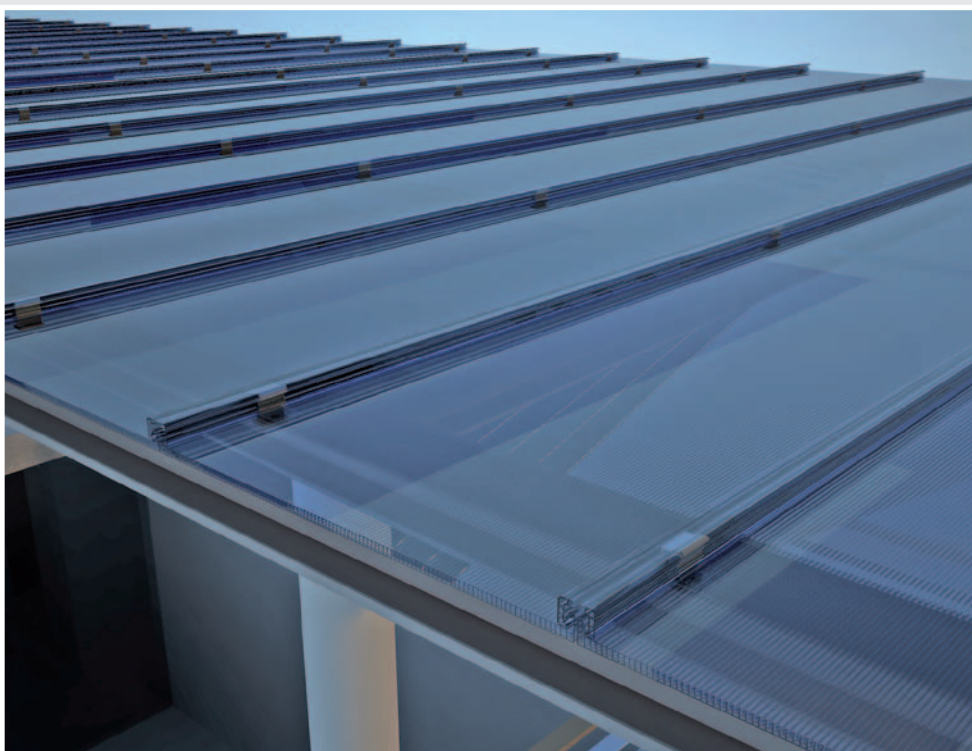

CONTINUOUS ROOFING

Example of roofing with polycarbonate cover plate.



LOAD RESISTANCE

Maximum loads on two supports

Values below refer to product installed according to the Technical Handbook Recommendation

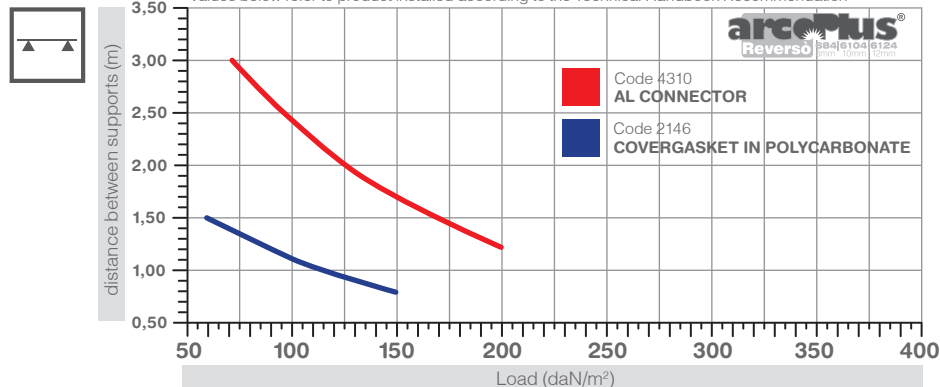

Maximum loads on more supports

Values below refer to product installed according to the Technical Handbook Recommendation

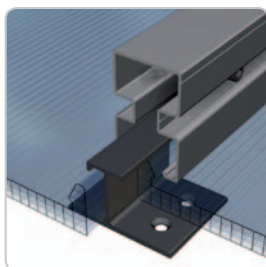
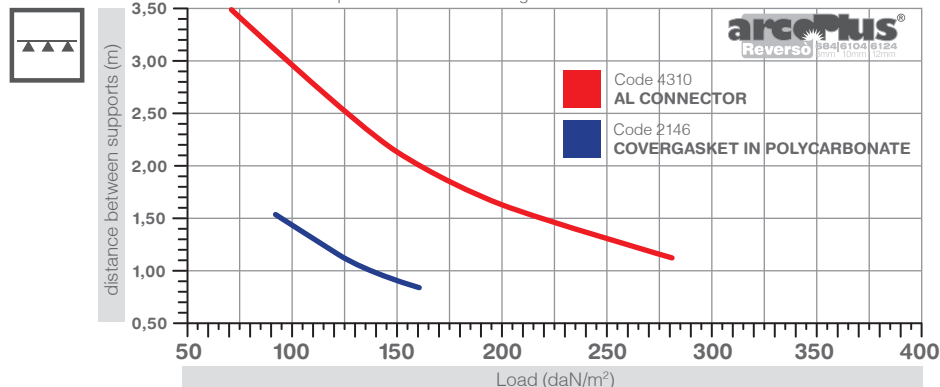

SYSTEM WITH ALUMINIUM CONNECTOR CODE 4310

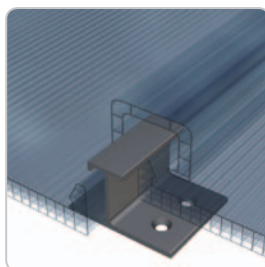

SYSTEM WITH POLYCARBONATE COVERGASKET - CODE 2146

EASY AND LOW-COST INSTALLATION

To ensure compliance with snow load and negative wind load resistance requirements, anchor brackets should be fitted for each purlin.

The polycarbonate panels are fastened to the underlying structure using specific brackets, which must be anchored to the purlins using suitable self-drilling/self-tapping screws (on metal structures) and tap bolts (for

wooden structures). These screws and bolts are not supplied.

Different connector profiles can be used, depending on the required load specifications.



COMPLETE SYSTEM FOR ROOFING

The modular polycarbonate panels can be used to create flat or curved roofing. They are fixed to the supporting structures using specific aluminium brackets.

Depending on the load capacity values required, or the distance between

the purlins of the underlying structures, either polycarbonate cover plates can be used or, for greater strength, aluminium connectors.

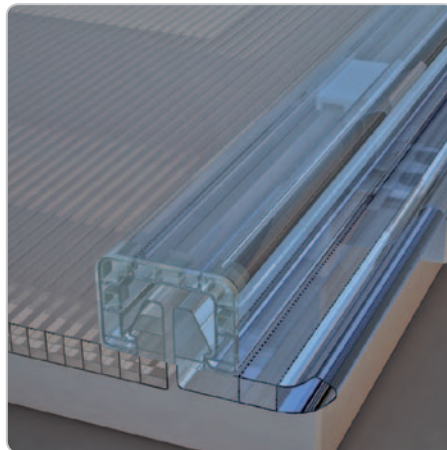

START PROFILE

Detail of insertion of start profile on roof.

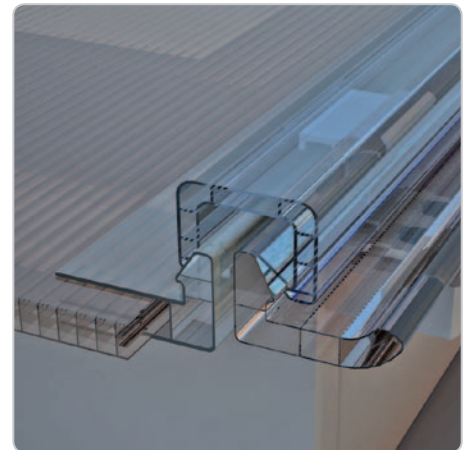

END PROFILE

Detail of insertion of section-breaker profile to complete roofing.

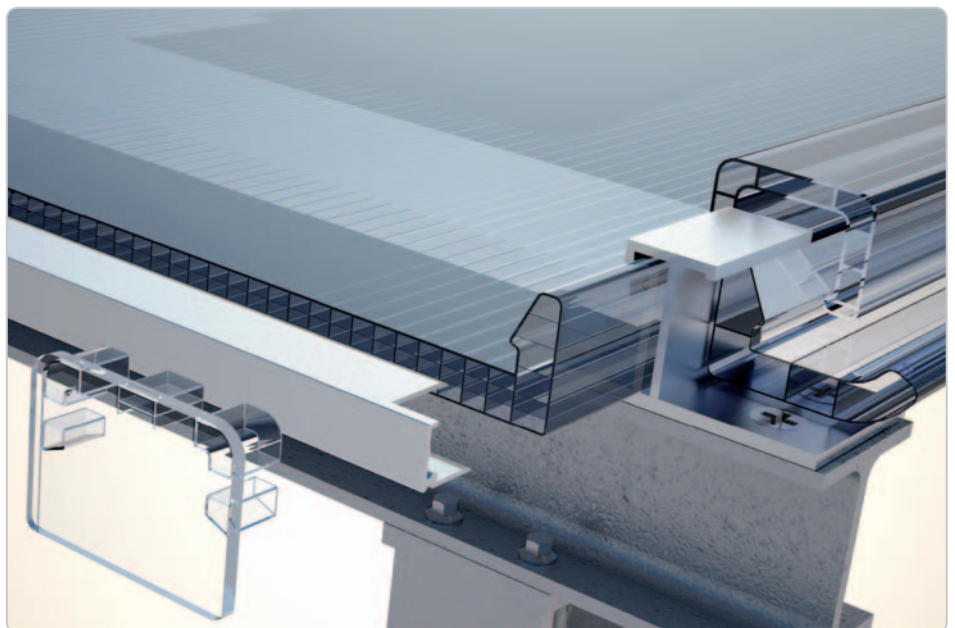

DETAIL OF COMPLETE SYSTEM

Start profile with panel, cover plate, plate and air cell cover profiles.



ACCESSORIES

The arcoPlus® system includes a complete range of accessories to facilitate installation. For correct installation the ends of the air cells in the panels must be heat-sealed to prevent soiling on the inside.

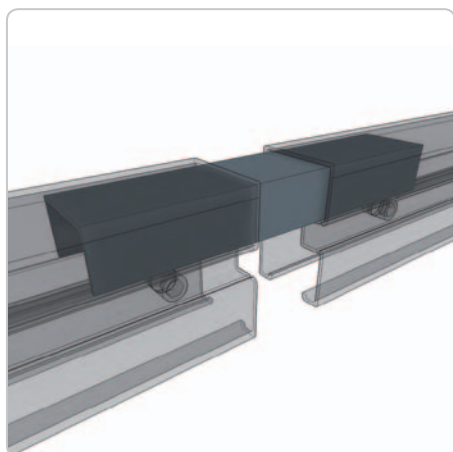

CONNECTOR JOINT
AL connector profiles with eclipse.

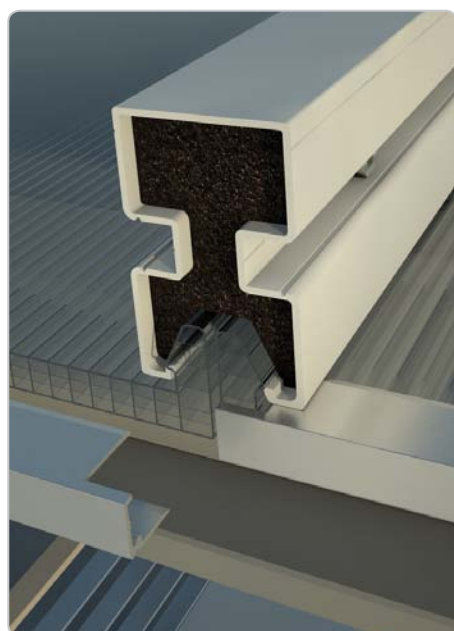

DETAIL OF CONNECTOR
Use of aluminium joint screwed down and end closed with PE-LD pad.

METAL PROFILES

code 4310
Connector AL
profile with screw

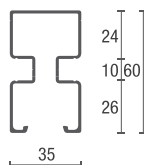

code 4245
U-shaped closing
support in AL

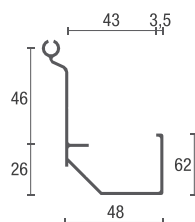

code 4252
Closing
support in AL



4213 dim. 40x35x580
4221 dim. 70x40x580
Pad PE-LD



4318
Pad PE-LD
for connector



4329
Sealing tape PE-LD
4x15mm



4316 M6 nut
4315 M6 x 20 screw
Accessories for connector

ACCESSORIES



4303
Covergasket
stopper



2146
Covergasket
in polycarbonate



2282
Double connector
in polycarbonate

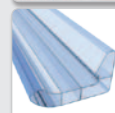

2147
Start profile 684-6104
in polycarbonate

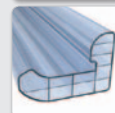

2245
Start profile 6124
in polycarbonate

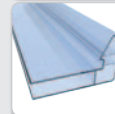

2148 th.8mm
2265 th.10mm
2250 th.12mm
End profile in PC



4310
Connector AL
profile with screw

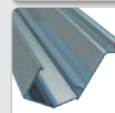

4245
U-shaped closing
support in AL

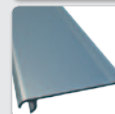

4252
closing
support in AL



4319/200
AL eclipse
for connector



4326 th.8mm
4350 th.10mm
4355 th.12mm
AL plate



4264
Stainless steel plate
for vertical connection



4138
Stainless steel plate
for flat connection
(th.8mm)



4675/600 th.8mm
4676/600 th.10mm
4677/600 th.12mm
Block cover AL profile