

Modular connector system composed of UV protected multiwall polycarbonate panels for façade installation and wall cladding

PRODUCTION STANDARDS

Panel	684	626	9207	9327
Thickness (mm)	8	20	20	32
Structure (walls)	4	6	7	7
Effective modular width (mm)	600	600	900	900

DESCRIPTION

ArcoPlus®VT is a modular system specially designed for façade cladding and ventilated façade: it can be composed of 4 different types of modular multiwall polycarbonate panels characterized by a thickness of 8, 20 or 32 mm and by a effective modular width of 60 or 90 cm. The system is also equipped with both aluminum frame profiles and polycarbonate corner profiles in order to create a real protective wrapping envelope for each kind of buildings.

TECHNICAL FEATURES

Thermal transmittance U (W/m²K)	3,0	1,7	1,7	1,3
Linear thermal expansion	0,065 mm/m°C			
Temperature range	-40°C +120°C			
U.V. rays protection	Coextrusion			
Fire reaction EN 13501-1	EuroClass B-s1,d0			

SPECIAL TREATMENTS



APPLICATIONS

- Curtain wall cladding
- Ventilated façade

CERTIFICATIONS



Document Technique d'Application n°2/13-1551 published on 14th 08/2013



LOAD RESISTANCE

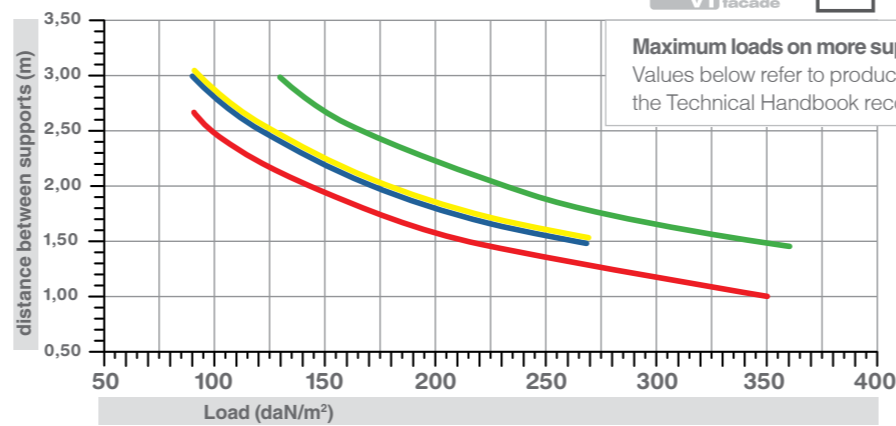

INSTALLATION DETAILS



JUNCTION OF ADJACENT PANELS
Paneling fixing to the masonry bearing wall, maintaining the cavity to fit insulation material and to allow air-circulation

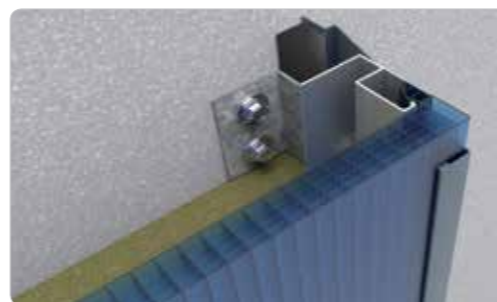

CLOSURE OF CLADDING SIDE
Suitable to fix the of paneling and side-ending with Al terminal profile



SEAMLESS CONTINUITY FOR WALL-CORNERS
Corner profile in polycarbonate fixed to the appropriate profile in Al anchored to the wall



DETAIL OF CLADDING BASE INSTALLING
Installation of profile 4271 to create facade base-support using panels th.20 mm

ALUMINUM PROFILES

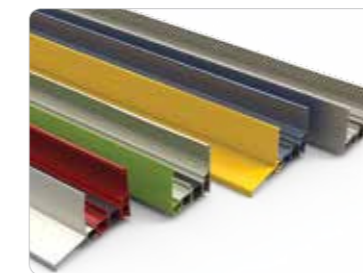

PROFILES WITH DIFFERENT COLORS
Diversify the color between the inner and outer side of wall paneling



DIFFERENT TYPES OF FACE FLAP
Curved and straight shapes

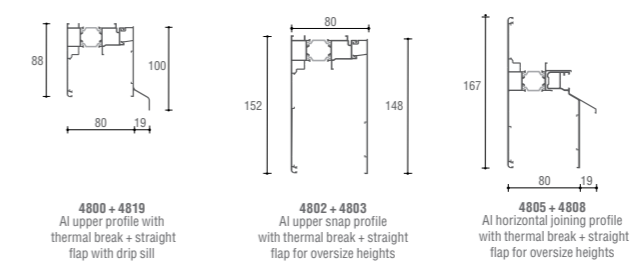

4800 + 4819 Al upper profile with thermal break + straight flap with drip sill
4802 + 4803 Al upper snap profile with thermal break + straight flap for oversize heights
4805 + 4808 Al horizontal joining profile with thermal break + straight flap for oversize heights

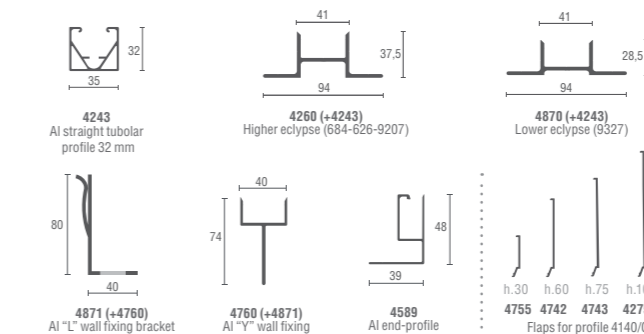

4243 Al straight tubular profile 32 mm
4250 (+4243) Higher eclipse (684-626-9207)
4870 (+4243) Lower eclipse (9327)
4871 (+4760) Al "L" wall fixing bracket
4760 (+4871) Al "Y" wall fixing bracket
4589 Al end-profile
4755 4742 4743 4275 Flaps for profile 4140/C

ACCESSORIES



- 2147** th.8 mm
- 2179** th.20 mm
- 2710** th.32 mm
- PC starter profile
- 2148** th.8 mm
- 2180** th.20 mm
- 2712** th.32 mm
- PC terminal profile
- 4589**
- Al end profile
- 2550**
- PC corner 90° cover profile
- 4588/4738** th.20 mm
- 4740** th.32 mm
- Al corner profile (+2550)
- 4243**
- Al connector profile 32 mm (straight)
- 4271** th.20 mm
- Al base/side profile including flap 4140/B
- 4800** (+flap) th.32 mm
- Al base/side/upper profile with TB
- 4755** - h.30 **4743** - h.75
- 4742** - h.60 **4275** - h.100
- Al flaps (30,60,75,100 mm)
- 4809** (+4800)
- Al base/upper/side straight flap
- 4831** (+4800)
- Al base straight flap with drip sill
- 4819** (+4800)
- Al upper straight flap with drip sill
- 4801** (+4800)
- Al upper curved flap with drip sill
- 4804** (+4800)
- Al base/upper/side curved flap
- 4807** (+4800)
- Al base curved flap with drip sill
- 4802+4803** th.32 mm
- Al upper snap profile with TB for oversize heights with special straight flap for 9327 panel
- 4805+4808** th.32 mm
- Al horizontal joining profile with TB for oversize heights with straight drip sill flap for 9327 panel
- 4140/C** (+flap) th.8 mm
- Al base/side snap profile for th.8 mm
- 4899** th.32 mm
- Al rear pad
- 4760**
- Al "Y" wall fixing bracket for connector 32 mm (+4243+4871)
- 4871**
- Al "L" wall fixing bracket for facade system (+4760)
- 4260**
- Higher eclipse +4243 (684-626-9207)
- 4870**
- Lower eclipse +4243 (9327)
- 1169/B**
- Slip-coat rubber seal strip
- 1169/B/AGS**
- Overlap Slip-coat seal strip
- 4213** size 40x35x580
- 4465** size 50x35x875
- LPDE foam pad
- 4970/600** - th.8 mm
- 4974/600** - th.20 mm
- Al closing edge strip drip-free
- 4974/900** th.20 mm
- 4976/900** th.32 mm
- Al closing edge strip drip-free
- 1372**
- Internal PE base dripping eave (+4800)
- 4828**
- Flat plain aligner
- 4327/4950**
- Taping surcharge